

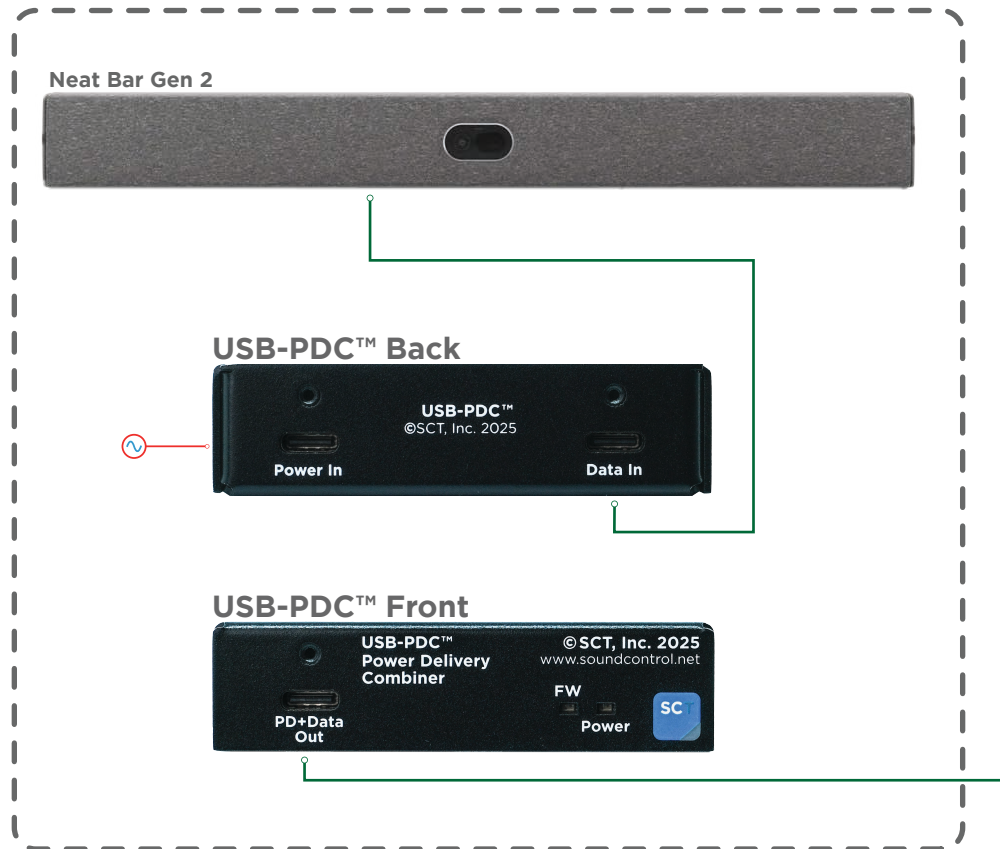

### Camera | Display Location

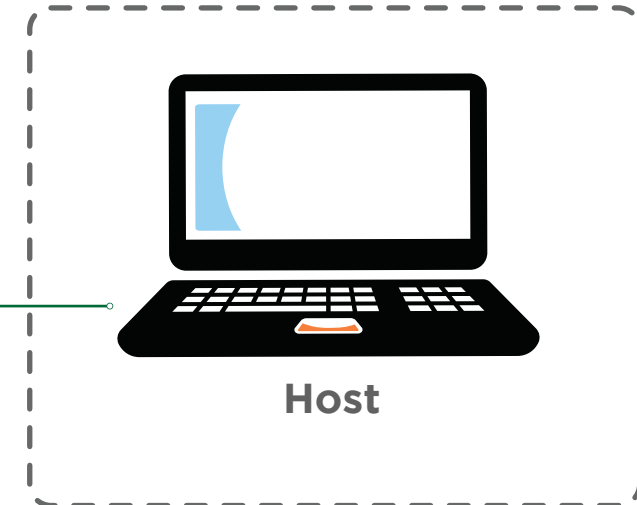

### End Point | Table Location



#### SCT B.O.M.

- USB-PDC™
- Single-Cable Power Delivery Combiner

#### KEY BENEFIT

Deliver up to 90W of charging power, high-speed USB 3.1 data over a single cable—simplifying BYOD/BYOM setups with secure locking connections and easy under-table mounting.

#### CABLE LEGEND

• SIGNAL TYPES •

SCT PROVIDES CABLES SPECIFICALLY FOR APPLICATION & DEVICES.

- Power
- USB 3.0/3.2