

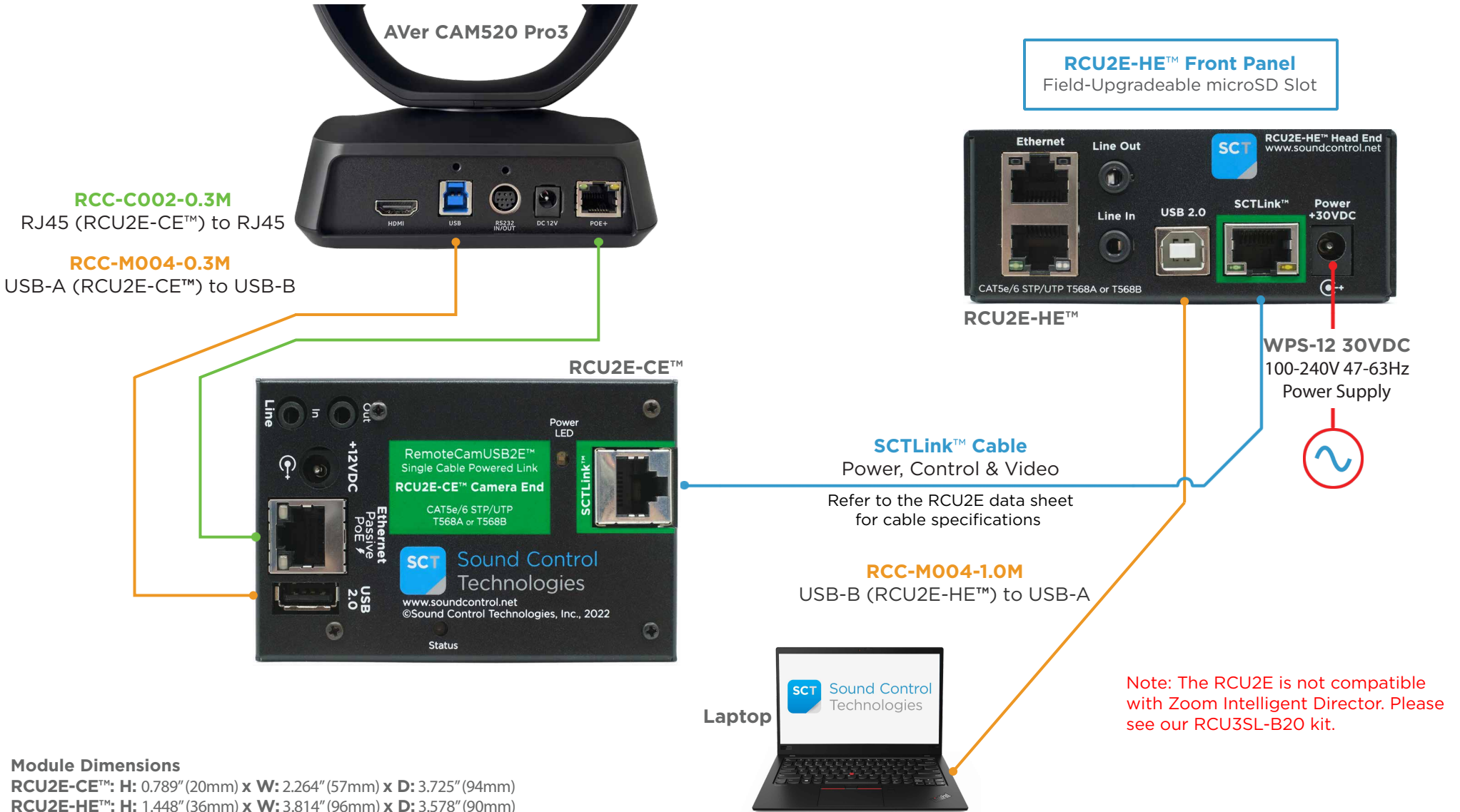

The **RCU2E-B00™** supports multiple camera models:

- 1Beyond IV-CAMFR-12
- 1Beyond AutoFramer
- 1Beyond AutoFinder
- 1Beyond IV-CAM-I12-B
- 1Beyond IV-CAM-I20-B
- AVer Cam550
- AVer Cam520 Pro Advanced
- AVer Cam570
- AVer Cam520 Pro2, Pro3 (shown)
- AVer TR313V2
- AVer TR323NV2
- AVer TR530+
- AVer TR333V2
- VDO360 Saber20X
- Sony SRG-XP1
- YeaLink UVC86
- VHD VX70IL
- VHD VX710N



Module Dimensions
RCU2E-CE™: H: 0.789" (20mm) x W: 2.264" (57mm) x D: 3.725" (94mm)
RCU2E-HE™: H: 1.448" (36mm) x W: 3.814" (96mm) x D: 3.578" (90mm)